

# ADA TRANSITION PLAN 2015 - 2019

## **FURNITURE-RELATED ITEMS**

OCTOBER 30, 2019

## ADA-Compliant Table Dimensions

At least five percent of seating (and no less than one) must be a minimum of:

- 27 inches High
- 30 inches Wide
- 19 inches Deep

19 inches deep

Tables cannot exceed 34 inches in height.

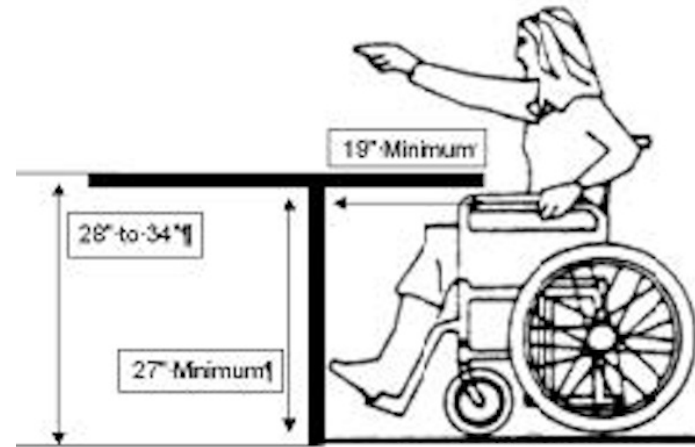

## Boykin Hall

3 items corrected

Lab Classes 207 & 208 - Lab Stations

- Labs remodeled with new lab stations



## Coffee Kiosk

1 item corrected

### Patio Seating

- New type of table added meeting 27"H x 30"W x 19"D requirements to allow for wheelchair access

Before



After



## East Physical Education (EPEK)

1 item corrected

Classrooms 101, 102, and 103

- 3 designated ADA-compliant tables were found elsewhere and were relocated to appropriate classrooms

Before



After



5

# Hasley Hall

5 items corrected

Computer Labs 206, 302-306

- 6 new ADA-compliant computer tables installed

Before



After



6

# Hasley Hall

5 items corrected

Classrooms 135, 203-205, 230, 232, 235

- Modesty panel infringing on minimum required depth
- 7 new ADA-compliant classroom tables without modesty panels installed

Before



After



- Quantity of seven (7): 24" x 60" classroom tables, Fixed height (at least 28" high knee space), and T-leg with glide on VCT
- Finish: Charcoal laminate/edgeband, and silver metallic legs (or silver whatever is standard)
- TAG: HH135, 203-205, 230, 232 & 235



G2 Gray

# Library

26 items corrected

Group Study Rooms 110, 209,  
210, 230

- 1/4" drum base infringing on minimum required depth
- Removed drum base and replaced with table legs

Before



8

After





# Library

26 items corrected

Open Areas 1<sup>st</sup> and 2<sup>nd</sup> Floor

- Table legs infringing on minimum required depth
- 3 ADA-compliant, adjustable height tables with privacy screens installed

Before

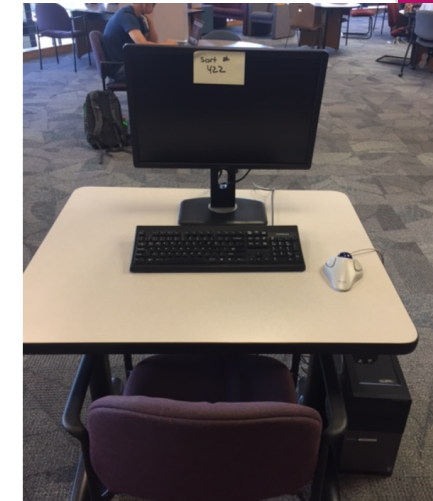

After



# Library

26 items corrected

Open Areas 1<sup>st</sup> and 2<sup>nd</sup> Floor

- Study carrels did not meet minimum required width & height
- Replaced old study carrels with ADA-compliant study carrels

Before



10



After



# Mentry Hall

9 items corrected

Photo Rooms 129,133 and Life Drawing Room 245

- ADA-compliant computer table installed
- Microwave without knobs installed

Before



After

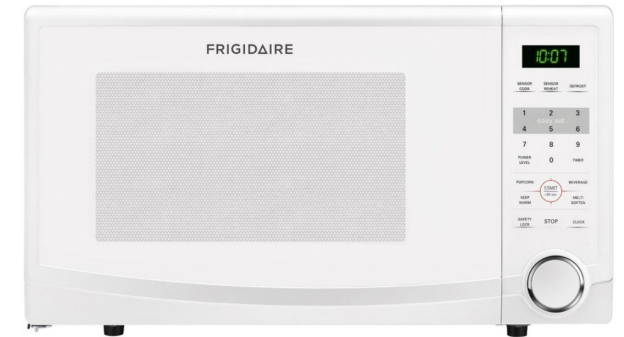
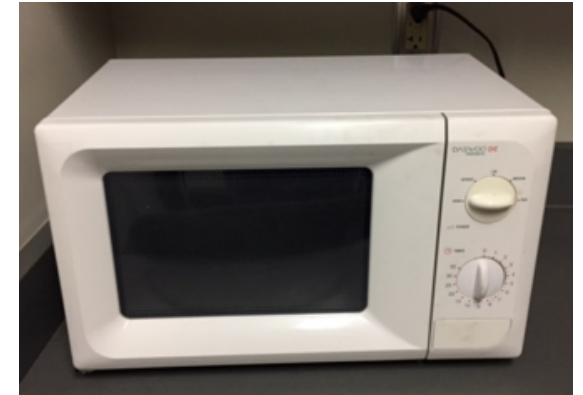

# Mentry Hall

9 items corrected

Classroom 234 & 301

- Tables did not meet minimum depth requirements
- New ADA-compliant classroom table installed
- New ADA-compliant drafting table installed

Before



12



After



## Outdoor Area Hasley Hall & East PE

2 items corrected

- 2 New ADA-compliant outdoor tables installed with opening for wheelchair access

Before



After



# Seco Hall

5 items corrected

DSPS Department

- Base infringing upon minimum depth & width
- New ADA-compliant conference table and computer lab table installed

Before

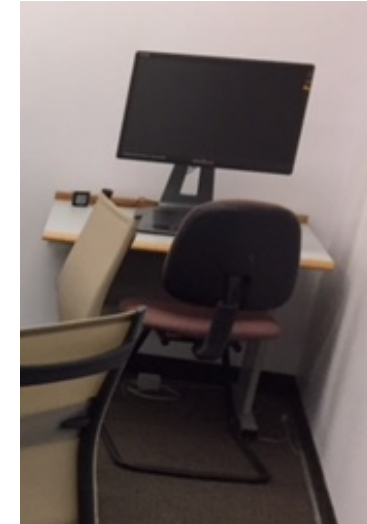

14

After

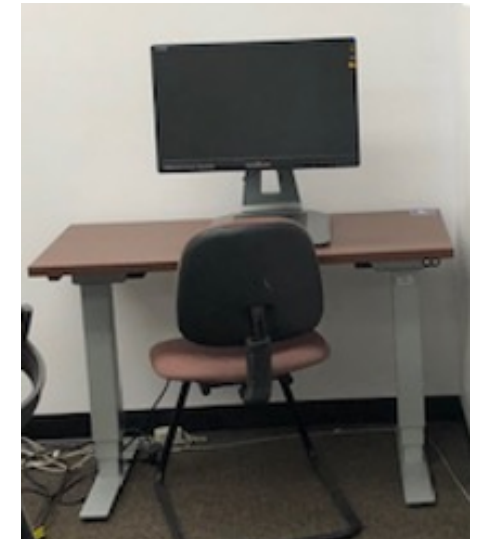

## Seco Hall

5 items corrected

3<sup>rd</sup> Floor Outdoor Seating Area

- New ADA-compliant picnic table installed
- Allows wheelchair to sit in middle of table, not at the end

Before



15

After



# Student Center

4 items corrected

ASG Computer Lab And  
Cafeteria Dining Area

- Star table base infringing upon minimum depth requirement
- 4 new ADA-compliant tables

Before



After





# Student Support Center

1 item corrected

Classrooms 118 & 119

- 3 ADA-compliant tables found in 118, moved to 119

Before



After



# Towsley Hall

3 items corrected

Welding Area Rooms 123 & 125

Work surface exceeded maximum height

Two new ADA-compliant, stainless steel tables installed

Before



After



18

## Towsley Hall

3 items corrected

Towsley #104 – MLT/Phlebotomy Lab

- Printer and other items that were blocking ADA-compliant workstation were removed

Before



After



19

# West Physical Education (WPEK)

1 item corrected

Classroom #108

- Tablet-arm chairs infringed upon minimum depth & width
- New ADA-compliant classroom tables installed

Before



After

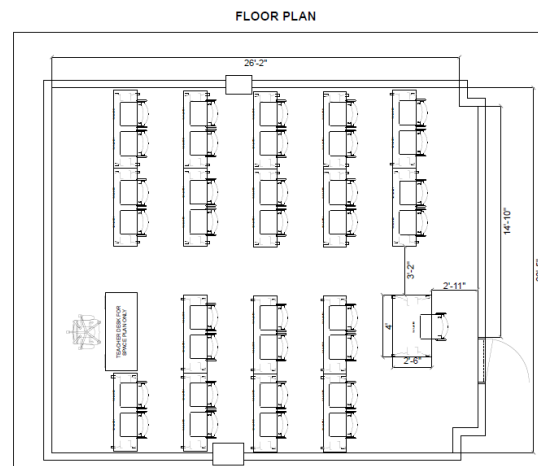

# Performing Arts Center (PAC)

1 item to be corrected

Due by 12/31/19

Balcony dining table with drum base to be replaced with 4 legged ADA-compliant table

Before



Proposed  
After

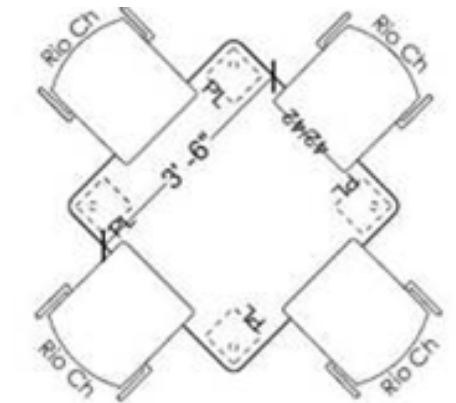

# The Learning Center (TLC)

## 21 items to be corrected

Due by 12/31/19

- Large Study Room: Purchase ADA-compliant computer table
- Assessment Center: Remove keyboard trays from 2 tables
- 4 Computer Labs: Purchase 1-2 ADA-compliant computer tables for each lab
- Testing Room: Purchase 1 ADA-compliant classroom table
- Open Area: Purchase 4-5 new ADA-compliant tables

Before

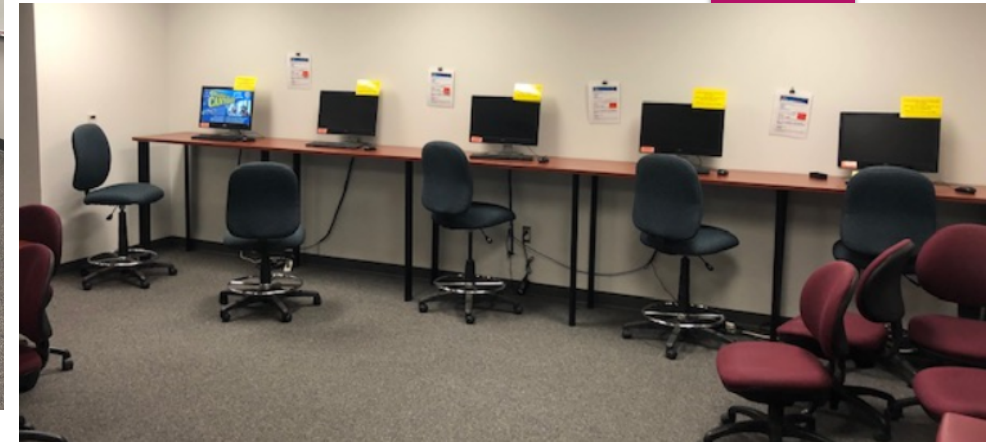

# University Center

14 items to be corrected

Due by 12/31/19

- Café & Lounge Areas: Purchase 3 ADA-compliant tables
- Lecture Room: Purchase deeper tables for front row
- Patio: Purchase ADA-compliant patio table
- Classrooms: Purchase 1-2 ADA-compliant table for each classroom

Before



23



## Summary

<b>Building</b>	<b>Furniture-Related Items</b>
Boykin Hall	3
Coffee Kiosk	1
East PE	1
Hasley Hall	5
Library	26
Mentry Hall	9
Outdoor Area (Hasley)	2
Performing Arts Center	1
Seco Hall	5
Student Center	4
Student Support Center	1
The Learning Center (TLC)	21
Towsley	3
University Center	14
West PE	1
<b>TOTAL</b>	<b>97</b>



Questions?